

MOZA iFocus Handunit

User Manual
用户手册

Handunit

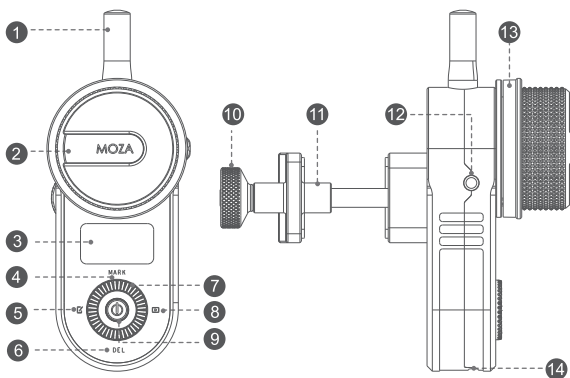

1 Antenna

2 Wheel

3 OLED Display Screen

4 Mark Button

5 REC Button

6 DEL Button

7 Dial

8 Play Button

9 Power Button

10 Knob Screw

11 Rod Clip

12 Multi-CAN Port

13 Mark Ring

14 USB-C Port

Getting Started

Installation

- Loosen the knob screw on the rod clip.
- Revolve the rod bar into the clip.
- Tighten the knob screw.

▲ Note: the rod clip of the handunit can clamp a rod bar with a diameter ranging from 15mm to 32mm.

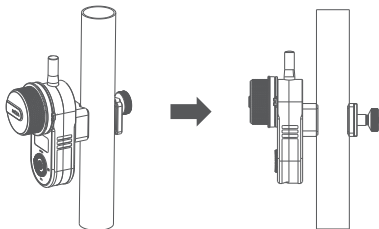

Charging

Connect the iFocus handunit to the charger via a USB-C cable, then the charging and battery level icon will be displayed on the screen. After the battery is fully charged, the charging icon will disappear.

Button Functions

Interface	Press	UP (MARK)	Down (DEL)	Left (REC)	Right (PLAY)	Power
Main interface	1x	—	—	—	—	Enter menu
	2x	—	—	Start/stop recording	Start/stop Playing	—
	Press for 3s	—	Clear AB points	Select recording No.	Select playing No.	Power off
	Hold	Mark AB points	—	—	—	Power off
Menu	1x	Item-up	Item-down	Return	Confirm	Return to the main interface
Remote control route calibration	Hold	Follow focus turns clockwise	Follow focus turns anticlockwise	—	—	Power off

On/Off

Turn On: Press and hold the power button for 3 seconds until the MOZA icon appears on the screen.

Turn Off: Press and hold the power button for 3 seconds in power-on status.

Status Display

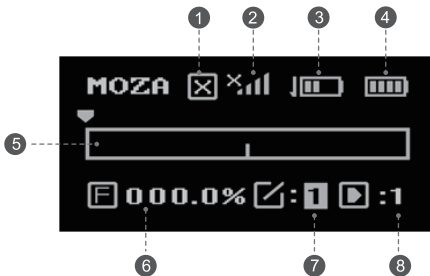

- | | |
|--|--------------------------------------|
| 1 Route Calibration Status | 5 Route Bar |
| 2 Wireless Connection Status | 6 Route Percentage |
| 3 Battery Indicator of iFocus motor | 7 Intelligent Guidance Record Number |
| 4 Battery Indicator of iFocus handunit | 8 Intelligent Guidance Play Number |

Connecting the iFocus Motor

Pair

- Turn off the iFocus motor.
- Turn on the handunit, enter the menu interface, and select wireless > pair > pairing.
- Turn on the iFocus motor and wait for 2 seconds until the handunit screen displays "Pair OK!".

⚠ Note: After the pairing is complete, please calibrate the route of the follow focus first to ensure it can be controlled. Please refer to page 4 for details.

Set A-B Endpoints

- Use the hand wheel to control the iFocus motor to move to the endpoint A.
- Press and hold MARK button until "A" appears on the route bar, then turn the hand wheel to move the iFocus motor to the end point B.
- Release the MARK button to complete the A-B endpoints setting.

Cancel the A-B Endpoints

With the white A-B endpoints bar displayed on the screen, long press the DEL button to cancel the A-B endpoints setting and restore the end point of route calibration.

Intelligent Guidance - Record

Long press the record button, then turn the dial to select the record number (1,2 and 3 are available).

- Double press the record button, the record number flashes and camera starts to record.
- Turn the wheel, and the movement data of follow focus motor will be recorded.
- Double-click the record button to ends recording.

 Note: the longest recording time is 1 minute.

Intelligent Guidance – Play

- Long press the play button, then turn the dial to select the record number (1,2 and 3 are available).
- Double press the play button, the play number flashes and video starts to play.
- The follow focus moves according to the recorded data, and will stop automatically when playing ends.

Menu Introducing

Wireless>

Pair> : pairing, please refer to page 3 for pairing operation

Motor>

Dir> : set the rotation direction of the follow focus motor

Rotate the dial to select CM (clockwise) or CCM (counterclockwise), and press the right button. When the screen displays [OK!], setting is completed.

Function>

Motor Calibrate> : follow focus motor route calibration

Mark the total distance of the lens focus ring by route calibration before using the iFocus and the lens position can be precisely controlled by the handunit.

The follow focus remembers the last calibration and needs not to be re-calibrated every time it is turned on unless the relative position of gear and focus ring is changed (The focus ring is turned manually or the follow focus is re-installed).

Manual-Hand

Click the right button to start the operation

- Manually rotate the lens focus ring to the starting point.
- Press the right button to confirm the starting point.
- Manually rotate the lens focus ring to the end point.
- Press the right button to confirm the end point.
- Click the left button to exit from calibration, or click the power button to return to the main interface.

Manual-Remote

Click the right button to start the operation.

- Press the up button to rotate the lens focus ring to the starting point.
- Press the right button to confirm the starting point.
- Press the down button to turn the lens focus ring to the end point.

- d. Press the right button to confirm the end point position.
- e. Press the left button to exit from calibration, or click the power button to return to the home interface.

Wheel Calibrate> :

The wheel is for controlling the movement of the follow focus. In general, the number is the smallest when it's rotated counterclockwise to the end, and when it's rotated clockwise to the end, the number is the largest. The wheel needs to be calibrated if it doesn't work well.

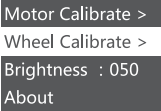

Click the right button first to start

- a. Turn the wheel to the start position (as shown), click the right button to confirm.

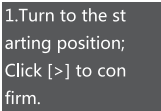

- b. Turn the wheel to the end position (as shown), click the right button to confirm.

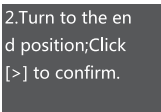

- c. Click the left button to exit from calibration, or click the power button to return to the home interface.

Brightness> :

Select the "Brightness" item, turn the dial to adjust the number. The larger the number, the brighter the screen display.

About> :

Display the firmware version of iFocus handunit.

Firmware Upgrading

The handunit can be upgraded separately or together with the follow focus motor.

- a. Turn off the handunit and follow focus first.
- b. Connect the handunit and follow focus via Multi-CAN, then connect the handunit to the computer with a USB-C cable.
- c. Long press the power button on the follow focus for 3s until the indicator light is on.
- d. Hold the down button and don't release, click the power button, "Boot Mode" pops up on the screen, the handunit enters the upgrade mode.
- e. Launch the MOZA Assistant software. After the firmware download is complete (which will take about 30s), click "upgrade" to start.
- f. After the upgrade is done, restart the handunit and follow focus motor.

Specifications

Weight (battery excluded)	165g
Dimensions	38*92*48mm
Operation Voltage	3.7V
Battery Capacity	750mAh
Upgrade/Charging Port	USB-C
Temperature	0--50 C

认识MOZA IFocus

遥控器

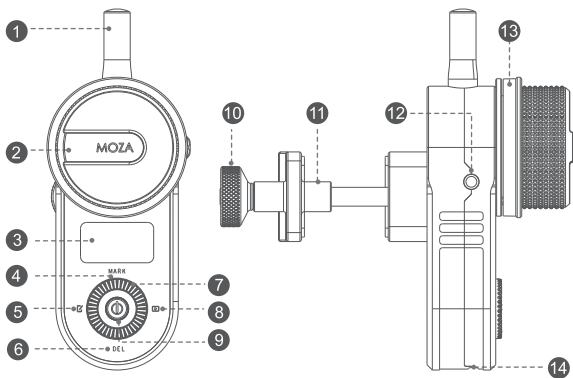

1 天线

2 手轮

3 OLED显示屏

4 MARK键

5 录制键

6 DEL键

7 拨盘

8 播放键

9 开关键

10 管夹锁紧螺丝

11 管夹

12 Multi-CAN接口

13 标记环

14 USB-C接口

安装

- 将管夹锁紧螺丝拧松；
- 将管夹套入安装遥控器的圆管上；
- 拧紧管夹锁紧螺丝。

⚠ 注意： 遥控器的管夹能夹持在直径为15mm到32mm的圆管上。

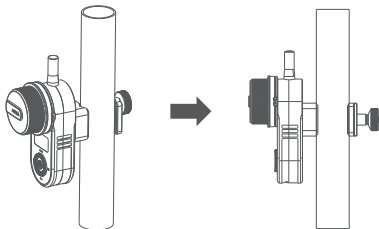

充电

使用USB-C线将遥控器连接到充电器，遥控器的显示屏会显示充电图标和电量，电池充满后，充电图标消失。

按键功能定义

界面	操作	上 (MARK)	下 (DEL)	左 (REC)	右 (PLAY)	电源
主界面	单击	——	——	——	——	进入菜单
	双击	——	——	开始/结束录制	开始/结束播放	——
	长按3s	——	清除 AB 点	选择录制编号	选择播放编号	关机
	保持	标记AB点	——	——	——	关机
菜单	单击	选择条上移	选择条下移	返回	确认	返回主界面
遥控行程校准	保持	跟焦器正转	跟焦器反转	——	——	关机

开机、关机

长按电源键3秒，屏幕上显示MOZA图标则开机成功。开机状态下，长按电源键3秒即关机。

状态显示

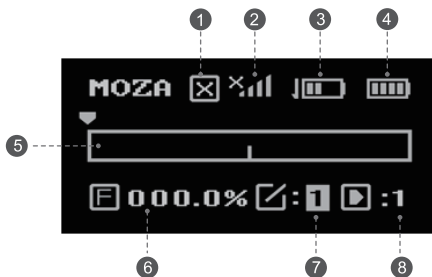

- | | |
|----------|------------|
| ① 行程校准状态 | ⑤ 行程显示条 |
| ② 无线连接状态 | ⑥ 智能示教播放序号 |
| ③ 跟焦器电量 | ⑦ 智能示教录制序号 |
| ④ 遥控器电量 | ⑧ 行程百分比 |

连接跟焦器

配对

- 关闭跟焦器；
- 打开遥控器，进入菜单，选择Wireless>Pair>Pairing；
- 跟焦器开机，等待2秒，遥控器屏幕会显示“Pair OK！”，配对完成。

⚠ 注意：配对成功后，需要先进行跟焦器的行程校准，才能正常控制跟焦器。参考第10页

设置A-B限位

- 用手轮控制跟焦器运动到限位A；
- 按住MARK键，当行程显示条出现A字样时，转动手轮控制跟焦器运动到限位B；
- 松开MARK键，A-B限位设置完成。

取消A-B限位

在屏幕上显示有白色A-B限位条的状态下，长按DEL键，可取消设置的A-B限位，恢复行程校准的限位。

智能示教功能-录制

- 长按录制按键，录制序号被选中，转动拨盘选择录制序号(可选1,2,3)；
- 双击录制按键，录制序号闪烁，开始录制；
- 操作手轮，跟焦器运动的数据将会被记录；
- 录制完成后，双击录制按键，结束录制。

▲ 注：录制最长时间为1分钟。

智能示教功能-播放

- 长按播放按键，播放序号被选中，转动拨盘选择播放序号(可选1,2,3)；
- 双击播放按键，播放序号闪烁，开始播放；
- 跟焦器按照录制的的数据运动，播放完成后，自动停止。

菜单介绍

Wireless>：无线

Pair>：配对，请参考第9页进行配对操作

Motor>：跟焦器电机设置

Dir>：设置跟焦器电机转动的方向

转动拨盘，选择Dir的值为CM（顺时针）或者CCM（逆时针），然后单击拨盘右键，屏幕显示[OK!]，设置完成。

Function>：功能

Motor Calibrate>：跟焦器行程校准

使用跟焦器前请通过行程校准来标记镜头的总行程，使遥控器能精确控制镜头的位置。

跟焦器将记录上一次的校准数据，关机后如果没有使齿轮与对焦环的相对位置发生变化(手动转动对焦环或者重新安装跟焦器)，就不需要再次进行校准。

Manual-Hand手动校准

点击拨盘右键开始操作。

- 手动将镜头跟焦环旋转到起始点；
- 点击遥控器拨盘右键，确认起始点位置；
- 手动将镜头跟焦环旋转到结束点；
- 点击遥控器拨盘右键，确认结束点位置；
- 点击拨盘左键退出校准，或者点击菜单键回到主界面。

Manual-Remote遥控校准

点击拨盘右键开始操作。

- 按住拨盘上键将镜头跟焦环旋转到起始点；
- 点击遥控器拨盘右键，确认起始点位置；
- 按住拨盘下键将镜头跟焦环旋转到结束点；
- 点击遥控器拨盘右键，确认结束点位置；
- 点击拨盘左键退出校准，或者点击菜单键回到主界面。

Wheel Calibrate> : 手轮校准

遥控器使用手轮控制跟焦器运动。正常情况下，手轮逆时针旋转到限位时数值最小，手轮顺时针旋转到限位时数值最大。如手轮异常，则需要进行手轮校准。

点击右键开始操作

Motor Calibrate >

Wheel Calibrate >

Brightness : 050

About

a. 将手轮转动到起始位置（如图），点击拨盘右键确认；

1.Turn to the starting position;
Click [>] to confirm.

b. 将手轮转动到结束位置（如图），点击拨盘右键确认；

2.Turn to the end position;Click [>] to confirm.

c. 点击拨盘左键退出校准，或者点击菜单键回到主界面。

Brightness> : 屏幕显示亮度调节

选中Brightness后，转动拨盘，可以从0到100调节其数值，数值越大，屏幕亮度越高。

About> : 关于

查看遥控器固件版本信息。

固件升级

iFocus遥控器可以自己单独升级，也可以连接上iFocus跟焦器一起升级。升级操作如下：

- 将跟焦器和遥控器关机；
- 用Multi-CAN连接跟焦器和遥控器，使用USB-C连接遥控器和电脑；
- 长按跟焦器电源键3s，直至白灯点亮；
- 按下方向键下键，不要松开，然后单击电源键，屏幕上会显示‘Boot Mode’，即进入固件升级状态；

- e. 启动MOZA Assistant软件，软件会自动进入升级界面，等待固件下载完成后，点击 ‘升级’ 按钮，等待约30秒；
- f. 升级过程中，遥控器屏幕会显示 ‘Upgrading’ ，升级完成后，屏幕会显示 ‘Upgrade success’ ；
- g. 重启跟焦器和遥控器即可。

规格参数

重量 (不带电池)	165g
尺寸	38*92*48mm
工作电压	3.7V
电池容量	750mAh
升级/充电接口	USB-C
工作温度	0-50°C

产品保修卡

用户资料

产品型号	MOZA iFocus Handunit
购买日期	
姓 名	
电 话	
地 址	

产品保修条例

保修期

自购机日起，遥控器主体保修12个月；电机、电池保修3个月。设备外壳、说明书、线材、包装等不在“一年免费保修服务”范围内，您可以选择有偿服务。

七日内免费退货

自购机日起7日内，根据国家最新三包规定，您可以选择退货（按票面金额一次性退清货款）、换货（更换同型号同规格的产品）或修理。

八至十五日免费换货或修理

自购机日起第8日至第15日内，主机出现性能故障，并经特约维修中心检测，确认非人为损坏的本身质量问题，您可以选择换货(更换同型号、同规格产品)或修理；但是更换的范围，只限于产品主机，其他配件无质量问题，不能更换；购买者在以下条件下不享受免费保修服务，您可以选择有偿服务。

1. 超过三包有效期的
2. 无三包凭证及有效发货票的，但能够证明该产品在三包有效期内的除外
3. 包修凭证上的型号与修理产品型号不符或者涂改的
4. 非本公司特约维修人员拆动造成损坏的
5. 因不可抗力造成损坏的
6. 未按产品使用说明书要求使用、维护、保养而造成损坏的

合格证

检验员：_____

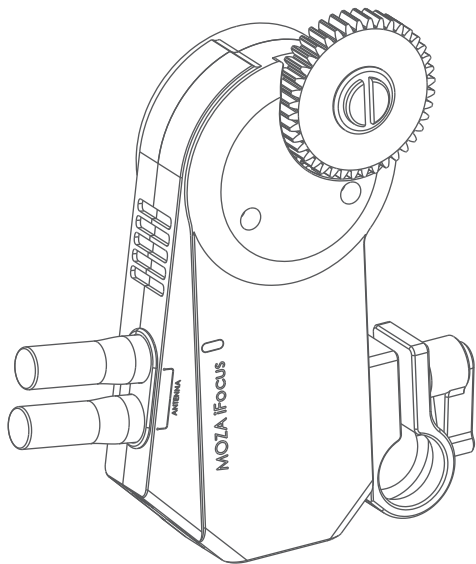

MOZA iFocus

User Manual
用户手册

In the Box

装箱清单

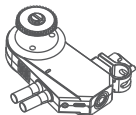

x1

Motor
跟焦器

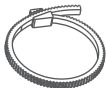

x1

Lens Gear Ring
跟焦环



x1

Multi-CAN Cable
Mutli-CAN连接线



x1

User Manual
用户手册

Note:

This manual only guides the connecting and using methods and precautions used by the follow focus motor part in conjunction with Moza Air 2, and does not fully describe all the functions of the follow focus.

For more functions, please use it with the remote control.

注意事项：

本说明书仅指导跟焦器电机部分与MOZA Air 2搭配使用的连接使用方法及注意事项，并未完整说明跟焦器的所有功能。

如需实现更多功能，请搭配遥控器使用。

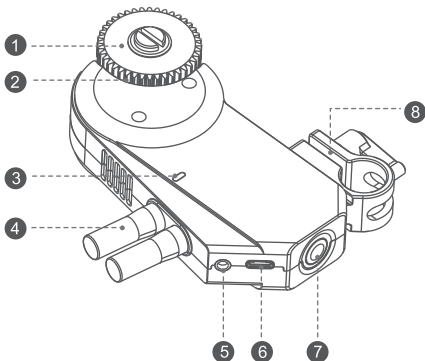

- 1 Gear:** Turns the gear ring on the camera lens.
- 2 Gear Knob:** Secures the gear to the motor.
- 3 Status Indicator:** Displays the system status and battery level.
- 4 Antenna**
- 5 Multi-CAN Port:** Allows the gimbal to communicate with the motor.
- 6 USB-C:** Used to charge the motor.
- 7 Power Button:**
Press and hold for 1 second until the green indicator lights up to power on the motor.
Press and hold for 3 seconds until the white indicator lights up to enter firmware grade.
Press and hold for 1 second until the red indicator flashes to power off the motor.
- 8 Quick Release Mount:** Mount the iFocus to a 15mm rod.

Getting Started

1. Mount the Lens Gear Ring

- Fits the lens gear ring with your camera lens.
- Tighten the clip.

⚠ Note: Ensure the clip is tight and that the lens gear ring makes good contact with the lens. You may also use a standard 0.8 Mod lens gear ring of your own.

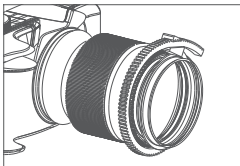

2. Mount the Motor

- Loosen the knob(1) on the quick-release mount and slide the motor onto the support rod(2). Tighten the knob to secure the motor's position on the support rod.

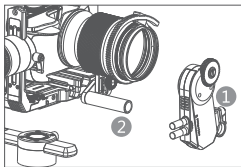

- Tighten the knob(1) to secure its position. Ensure the motor gear(2) and lens gear ring(3) make good contact.

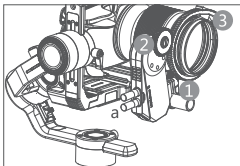

3. Connect to MOZA Air 2

Connect iFocus to MOZA Air 2 with Multi CAN cable.

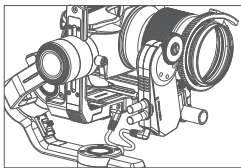

Functions of MOZA iFocus

1. System Status Indicator

The description of LED:

State	LED	Description
Upgrading Mode	White light	Firmware Upgrade Mode
On	Green blinks	Remaining capacity over 70%
	Bluetooth blinks	Remaining capacity: 30%~70%
	Red blinks	Battery low
Off	Blue solid light	Charging

2. Charging

Charge the iFocus with USB-C. Then LED light turns blue. When fully charging, the light goes off automatically.

When connecting iFocus to MOZA Air2 with Multi-CAN cable, Air 2 can charge iFocus.

3. Turn on and turn off

Long press the power button for 1 second, and the light turns green. The motor turns on.

Long press the power button for 1 second and red light blinks twice. The motor turns off.

4. Route Calibration

Mark the total distance of the lens focus ring by route calibration before using the iFocus to avoid rotating the motor over the route of lens focus ring.

The motor remembers your last calibration and does not need to be re-calibrated every time it is turned on unless you change the motor position or remount it after the motor has been shut off.

The operations of route calibration are as follows:

- Enter the Air 2 menu, and select Advanced>iFocus>Turn off to turn off the iFocus motor.
- Manually rotate the lens to the start point, then select Advanced>iFocus>Start point to confirm the start point.

c. Manually rotate the lens to the end point, then select Advanced>iFocus>End point to confirm the end point. The iFocus motor will start automatically.

⚠ Note: The iFocus motor can be turned on by selecting Advanced > iFocus> turn on during calibration. Note that if the start and end points are not calibrated, the calibration is invalid.

5.Control iFocus movement by Air 2

- Enter the Air 2 menu, Gimbal Set>Operations>Wheel>Function>Focus-1 or Focus-2 to select the wheel to control the follow focus. You could also press the Mode button on the Air 2 until the wheel mode on the screen turns to Focus-1 or Focus-2 mode.
- Rotate the wheel to control the motion of iFocus

6.iFocus Control Sensibility Settings

Enter the Air 2 menu, and select Gimbal Set>Operations>Wheel>Sensi to adjust the control sensibility.

⚠ Note: Turn down the sensibility level if the iFocus rotates too fast, and turn the level up if the iFocus rotates too slowly.

Firmware Upgrade

iFocus needs to be connected to MOZA Air 2 for firmware upgrade.

- Connect the iFocus to MOZA Air 2 via Multi-CAN cable.
- Long press the power button for 3 seconds in power off status until the white indicator lights up.
- Follow MOZA Air 2 firmware instruction to upgrade the firmware.
- Restart the iFocus and MOZA Air 2 after the upgrade is complete.

Specifications

Weight(battery excluded)	198g
Dimensions	115*65*30mm
Operating Voltage	7.2V
Battery Capacity	600mAh
Bluetooth	Support
Charging Port	USB-C

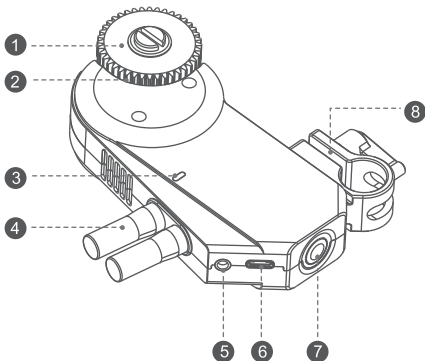

- 1 齿轮：**通过与跟焦环啮合，调节镜头对焦、光圈或变焦
- 2 齿轮固定螺丝：**用于固定齿轮
- 3 状态指示灯：**指示跟焦器电量、工作状态等信息
- 4 天线**
- 5 Multi CAN接口：**供电与通信接口，可连接MOZA Air2
- 6 USB-C：**给跟焦器充电
- 7 电源键：**
关机状态下长按1s，状态指示灯绿灯亮起，跟焦器开机
关机状态下长按3s，状态指示灯白灯亮起，进入升级模式
正常工作或升级模式下长按1s，状态指示灯红灯闪烁后关机
- 8 跟焦器管夹：**将跟焦器固定到15mm的跟焦管上

安装

1. 安装跟焦环

- a. 用跟焦环围住镜头对焦环，拉紧跟焦环
- b. 将跟焦环两端的固定结构锁紧

⚠ 注意：务必使跟焦环与镜头对焦环卡紧，且转动跟焦环的时候镜头对焦环能同步转动
跟焦环也可安装至光圈环与变焦环，请根据需要选择安装的位置

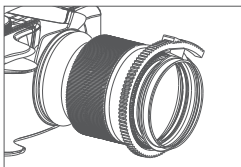

2. 安装跟焦器

- a. 将跟焦器管夹1套入跟焦安装管2，上下调节跟焦器到合适的位置

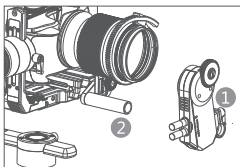

- b. 拧紧跟焦器管夹上的旋钮1，使跟焦器齿轮2与跟焦环3咬合

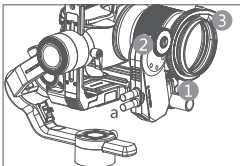

3.连接MOZA Air2

使用Multi CAN线连接MOZA Air2和跟焦器。

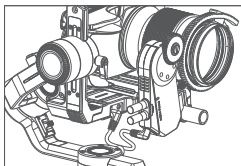

跟焦器功能

1. LED灯状态

LED灯定义如下：

状态	灯光	含义
升级模式	白灯亮	固件升级模式
开机	绿色闪烁	剩余电量高于70%
	蓝牙闪烁	剩余电量30%~70%
	红色闪烁	电量不足
关机	蓝色灯常亮	正在充电

2.充电

使用USB-C给跟焦器充电，跟焦器LED灯显示为蓝色，充满后自动熄灭。

当iFocus和MOZA Air2使用时，插上Multi-CAN连接线，跟焦器可以从MOZA Air2取电

3.开机、关机

长按电源键1秒，直到跟焦器亮绿灯，松开按键即可。开机状态下，长按电源键1秒，红色指示灯闪烁两次，跟焦器关机。

4.行程校准

使用跟焦器前请通过行程校准来标记镜头对焦环的总行程，以避免跟焦器转动超过镜头对焦环的行程。

跟焦器将记录上一次的校准数据，关机后如果没有使齿轮与对焦环的相对位置发生变化（手动转动对焦环或者重新安装跟焦器），就不需要再次进行校准。

行程校准的操作如下：

- 进入Air2菜单，选择Advanced>iFocus>Turn off 关闭跟焦器电机
- 手动转动镜头到起始位置，然后选择Advanced>iFocus>Start point确认行程起始位置
- 手动转动镜头到终点位置，然后选择Advanced>iFocus>End point确认行程终点位置，这时跟焦器电机会自动启动

⚠ 注意：校准过程中选择Advanced>iFocus>Turn on即可开启跟焦器电机。如果没有将起点与终点都校准好就启动，则本次校准无效

5.Air2控制跟焦器运动

- 进入Air2菜单， Gimbal Set>Operations>Wheel>Function>Focus-1或者Focus-2选择滚轮控制跟焦器。也可以按Air2的M键，直到Air 2屏幕上的手轮模式变为F1或者F2
- 转动滚轮即可控制跟焦器运动

6.跟焦器控制灵敏度设置

进入Air2菜单， Gimbal Set>Operations>Wheel>Sensi调节控制的灵敏度。

⚠ 注意：您在使用时，如果觉得跟焦器转动太快，可以降低跟焦器控制灵敏度；如果觉得跟焦器转动太慢，可以升高跟焦器控制灵敏度

固件升级

iFocus跟焦器不能独自进行固件升级，需要连接到MOZA Air 2上，与MOZA Air 2一起升级固件。

- 将跟焦器与Air2通过Multi-CAN线连接
- 关机状态下长按跟焦器电源开关3s直到LED等显示为白色
- 按照MOZA Air 2的固件升级操作，进行升级
- 升级完成后，重启跟焦器和MOZA Air 2即可正常工作

规格参数

重量（不带电池）	198g
尺寸	115*65*30mm
工作电压	7.2V
电池容量	600mAh
蓝牙	支持
蓝牙充电接口	USB-C

产品保修卡

用户资料

产品型号	MOZA iFocus
购买日期	
姓 名	
电 话	
地 址	

产品保修条例

保修期

自购机日起，跟焦器主体保修12个月；电机、电池保修3个月。设备外壳、说明书、线材、包装等不在“一年免费保修服务”范围内，您可以选择有偿服务。

七日内免费退货

自购机日起7日内，根据国家最新三包规定，您可以选择退货（按票面金额一次性退清货款）、换货（更换同型号同规格的产品）或修理。

八至十五日免费换货或修理

自购机日起第8日至第15日内，主机出现性能故障，并经特约维修中心检测，确认非人为损坏的本身质量问题，您可以选择换货(更换同型号、同规格产品)或修理；但是更换的范围，只限于产品主机，其他配件无质量问题，不能更换；购买者在以下条件下不享受免费保修服务，您可以选择有偿服务。

1. 超过三包有效期的
2. 无三包凭证及有效发货票的，但能够证明该产品在三包有效期内的除外
3. 包修凭证上的型号与修理产品型号不符或者涂改的
4. 非本公司特约维修人员拆动造成损坏的
5. 因不可抗拒力造成损坏的
6. 未按产品使用说明书要求使用、维护、保养而造成损坏的



Get more functions with
the iFocus Handunit.

搭配遥控器，玩出新花样

GUDSEN

INVENTED FOR VIDEO
Gudsen Technology Co., Ltd
Web: www.gudsen.com